

Settlement at Lost Creek

City of Sheboygan

- ◆ Large City Lots up to .6 acre
- ◆ Wide frontages for 3 car home designs
- ◆ Paved curb, gutter and roads included
- ◆ City sewer, water and storm

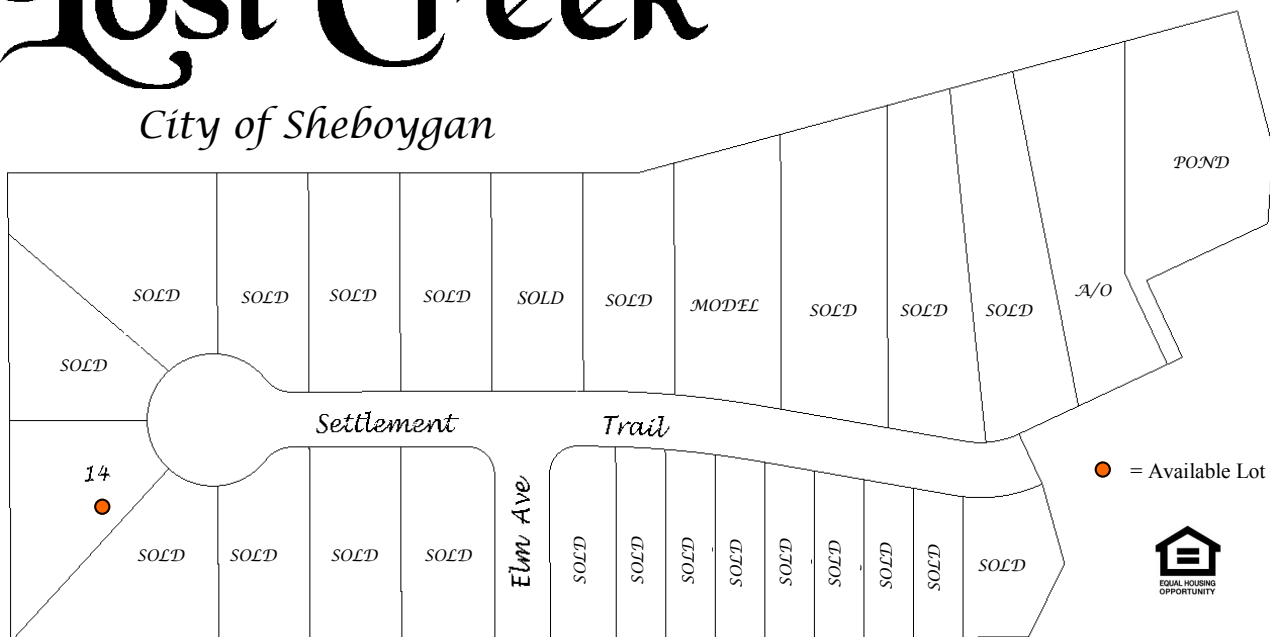

- ◆ 5/12 Roof pitch minimum
- ◆ 5' side yard setback (10' total)
- ◆ All subject to buyer entering into an acceptable building contract with Werner Homes prior to closing on lot
- ◆ City Park Impact Fee is by Buyer (2017- \$547)
- ◆ See condition report regarding fill and possible deeper stoops & garage foundation
- ◆ All sales subject to prior offer and all prices subject to change

Lots	Acres	Price
12	.31	SOLD
13	.41	SOLD
14	.39	\$39,900
21	.38	SOLD
22	.51	MODEL
26	.57	A/O

Come Visit Our Product Showroom Filled with Ideas !



- See our LARGE SELECTION of pre-priced ranch and two-story designs
- FURNISHED MODELS Available for TOUR
- Unique Trade-in Program of Current Home

Discover your Possibilities with Werner Homes



WERNER HOMES

Sheboygan County's Largest Home Builder

SHOWROOM LOCATION
4539 South Taylor, Sheboygan
920-458-4104 WernerHomes.com

Settlement

at Lost Creek

